



STORM™

by Inaxsys

INS44NVR1TBE

4 Channel 1TB NVR Storm Series Kit with 4 x 2.1MP (1080P) IP Eyeball Cameras



NVR Features

- Up to 4 IP camera input channels
- H.264/MJPEG dual codec decoding
- Maximum 80Mbps of incoming bandwidth
- Up to 5Mp resolution for preview & playback
- HDMI/VGA simultaneous video outputs
- 4 channel synchronized real-time playback, GRID interface
- Supports multiple brands of network cameras
- Conforms to ONVIF™ Version 2.4
- 3D intelligent positioning
- Supports 1 SATA HDD (up to 4TB), 2 USB ports 2.0
- Supports IP cameras UPnP and 4 PoE ports
- Multiple network monitoring

Camera Features

- 1/2.7" 2 megapixel CMOS
- H.264 & MJPEG dual-stream encoding
- 25/30 fps @1080P
- DWDR, Day/Night (ICR), AWB, AGC, BLC
- 2.8mm fixed lens
- Maximum length of IR LEDs: 30m, Smart IR
- IP67 rated, DC12V, PoE (802.3af)

INS44NVR1TBE

Cameras Specifications



STORM
by Inaxsys

Camera: INSEBO2IRF	
Image Sensor	1/2.7" 2 megapixel CMOS
Effective Pixels	1920 (H) × 1080 (V)
Electronic Shutter	1/60 - 1/30000s
Minimum Illumination	0.025 Lux /F2.1 with color, 0 Lux /F2.1 with IR ON
S/N Ratio	More than 50dB
Camera Features	
Maximum IR LEDs Length	30 m, Smart IR
Day/Night	Auto (ICR) / Color / B/W
Noise Reduction	3D
Privacy masking	Up to 4 zones
Lens	
Focal Length	2.8 mm
Viewing Angle	H: 93°
General	
Power Supply	DC 12V, PoE (802.3af)
Power Consumption	Less than 5W
Working Environment	-30°C to +60°C, less than 95% RH (no condensation)
Ingress Protection	IP67
Dimensions	113.6mm × 85.8mm
Weight	0.35 kg
Material	Metal and plastic

Popular Mounting Solutions

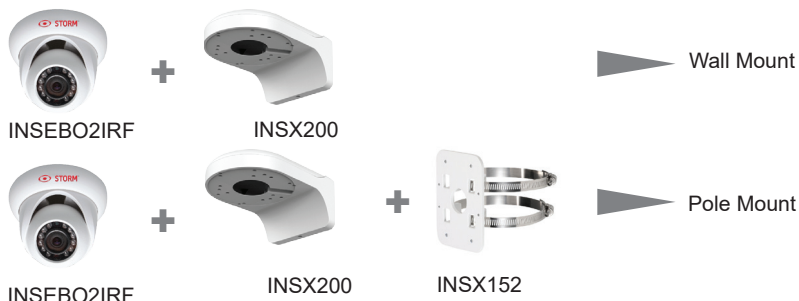

Dimensions (mm)

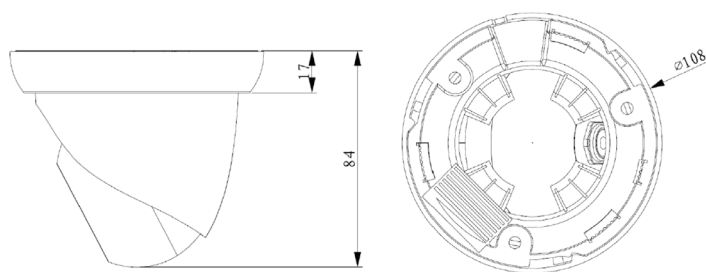

Junction Box Options



INS44NVR1TBE

Server Specifications



STORM
by Inaxsys

System: INS44NVR1T	
Main Processor	Dual-core embedded processor
Operating System	Embedded LINUX
IP Camera Input	4 channels
Two-way Audio	1 channel Input, 1 channel output, RCA
Display	
Interface	1 HDMI,1 VGA
Resolution	1920×1080, 1280×1024, 1280×720, 1024×768
Display Split	1/4
OSD	Camera Title, Time, Video Loss, Camera Lock, Motion Detection, Recording
Recording	
Compression	H.264/MJPEG
Resolution	5Mp (2560×1920) / 3Mp (2048×1536) / 1080P (1920×1080) 720P (1280×720) / D1 (704×576/704×480)
Record Rate	80Mbps
Bit Rate	48 - 8192kbps
Record Mode	Manual, Schedule (Regular / Continuous, MD, Alarm), Stop
Record Interval	1-120 min (default: 60 min), Pre-record: 1-30 sec, Post-record: 10-300 sec
Video Detection & Alarm	
Trigger Events	Recording, PTZ, Tour, Alarm, Video Push, Email, FTP, Buzzer & Screen tips
Video Detection	Motion Detection, MD Zones: 396 (22×18), Video Loss & Camera Obscured
Playback & Backup	
Sync Playback	1/4
Search Mode	Time/Date, Alarm, MD & Exact search (accurate to second), Smart search
Playback Function	Play, Pause, Stop, Rewind, Fast Play, Slow Play, Next File, Previous File, Next Camera, Previous Camera, Full Screen, Repeat, Shuffle, Backup Selection, Digital Zoom
Backup Mode	USB Device / Network / Internal SATA burner
Network	
Ethernet	1 RJ-45 port (10/100Mbps)
PoE	4 ports (IEEE802.3at/af)
Network Function	HTTP, TCP/IP, IPv4/IPv6, UPNP, RTSP, UDP, SMTP, NTP, DHCP, DNS, IP Filter, PPPOE, DDNS, FTP, Alarm Server, IP Search
Maximum User Access	128 users
Smart Phone	iPhone, iPad, Android
Storage	
Internal HDD	1 SATA port, up to 4TB
USB	2 ports,USB2.0
General	
Power Supply	Single, DC48V/1.5A
Power Consumption	NVR: 10W (without HDD)
	PoE: Max 25.5W for single port
Working Environment	-10°C to +55°C / 10%-90RH / 86-106kpa
Dimension	
W × D × H	Mini 1U, 325mm × 250mm × 55mm
Weight	1.25 Kg (without HDD)